

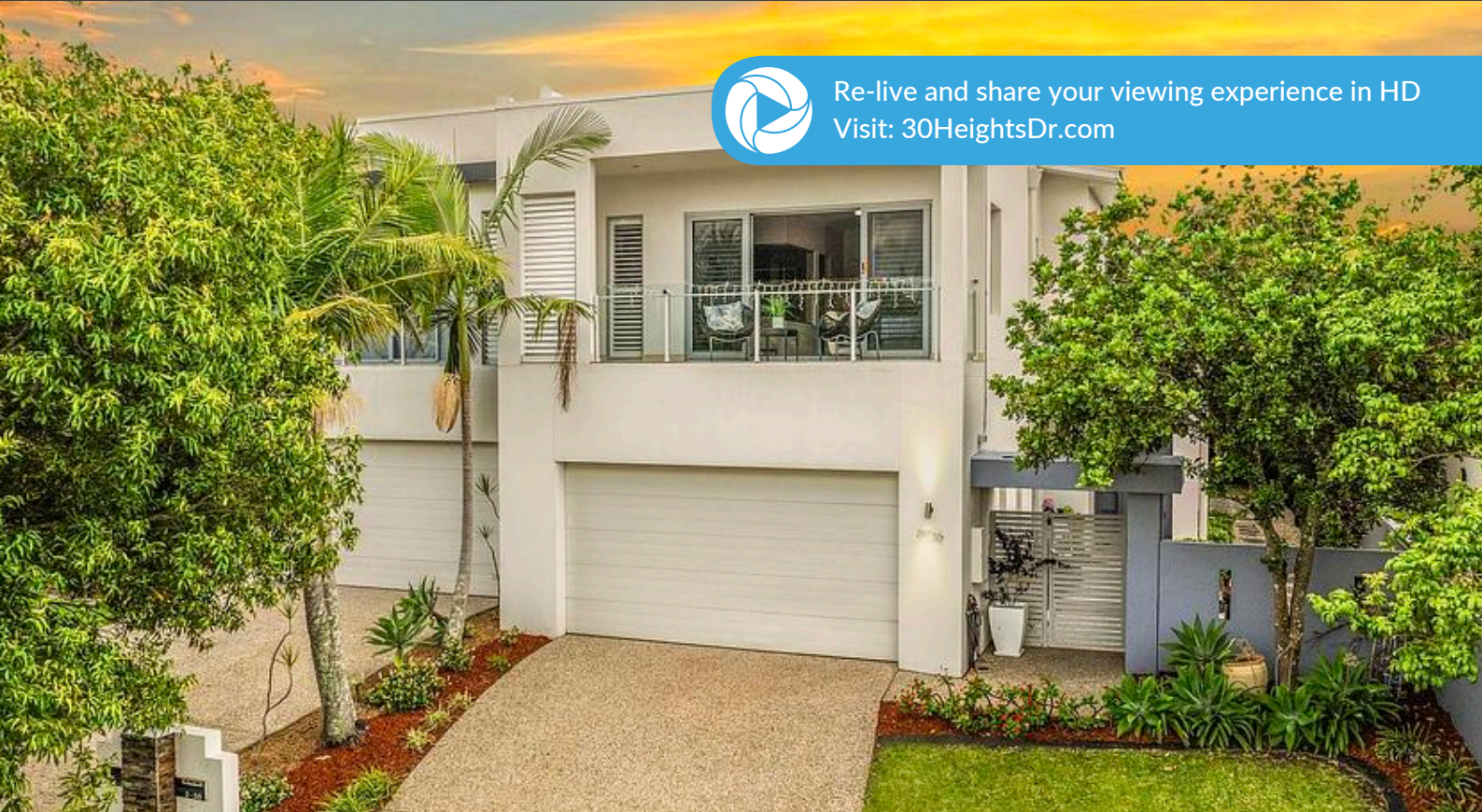

Re-live and share your viewing experience in HD
Visit: 30HeightsDr.com



'EFFORTLESS ELEGANCE, UNPARALLELED CONVENIENCE'



5  2.5  2  266m²



Property Overview

'EFFORTLESS ELEGANCE, UNPARALLELED CONVENIENCE'

Step into a lifestyle of effortless elegance in this beautifully designed five-bedroom home; perfectly positioned just moments from Robina Town Centre, top schools and the golden sands of Gold Coast beaches.

Set across two spacious levels, this property offers an ideal balance of luxury and liveability.

Your light filled internal living leads onto a covered patio and private backyard, setting the stage for lively gatherings and peaceful retreat alike. At its heart lies a sleek, open-plan kitchen appointed with premium Bosch appliances, stone benchtops, gas cooking and a breakfast bar – delivering everyday ease with a touch of sophistication.

Your expansive master suite offers a tranquil escape. Flaunting a chic walk-in-robe, spa ensuite and private balcony with hinterland views, you will appreciate this space.

Four additional bedrooms provide versatility for growing families, guests or additional living spaces.

This exceptional home truly delivers unparalleled convenience. With everything from major shopping and dining precincts, to transport, health care and top-tier education just minutes away; this is more than a home, this is a lifestyle.



View as Advertised or By Appointment
Auction: On site | Saturday, 21st June 2025 at 11:00am



"Heart of the Home"



"Family Movie Nights"



"Wine & Dine"



"Backyard Bliss"



"A Blank Canvas..."



"In the Heart of It All"

Property Specifications

- Centrally Located in the Heart of Robina
- Securely Fenced Property with Gated Entry
- Situated on the High Side of the Street
- North to Rear Perspective
- Easy to Maintain Block with Side Access
- Open Plan Internal Living & Dining Areas
- Light Filled & Framed by Louvre Windows
- Gourmet Kitchen with Premium Bosch Appliances
- Large Stone Island Bench Top & Breakfast Bar
- Outdoor Undercover Patio with Screens, Lights & Fan
- Large, Private Backyard with Leafy Green Outlook
- Ducted Air-Conditioning & Fans Throughout
- Separate Laundry with External Access
- Five Spacious Bedrooms
- Expansive Master Retreat with Walk-In-Robe, Spa Ensuite & Private Balcony with Hinterland Views
- Double Lockup Garage & Further Off-Street Parking
- Crimsafe Screens, Water Tank & Solar Panels
- Security System. Shared Building Insurance
- 750m Walk to Robina Town Centre, 550m Walk to Easy T Centre & A Direct Path to Bunnings, Petstock etc.
- Minutes to World Renowned Beaches & Countless Parks
- Close to Schools, Universities, Hospitals & Transport

Visit [30HeightsDr.com](https://30heightsdr.com)



Seller's Insights

"Once you become accustomed to living in this location you'll never want to leave... A hidden path leads you straight through to cafes and local shops; or walk a few hundred metres and arrive at your choice of Robina Town Centre or Easy T Centre! If you prefer, enjoy a stroll to nearby parks or hop straight on the train or bus North, South, East or West!"

"The master suite will quickly become your favourite place to unwind. Whether you're indulging in a spa bath, watching the sunset from your private balcony with hinterland views or simply soaking in the peace and privacy of this top-floor sanctuary."

"You will love the size of the backyard and outdoor entertaining area! There's no end to what you could do! Plus, the sense of privacy and security here is sure to win your heart, with Crimsafe screens, a security system and full fencing for peace of mind."

Market Analysis

1/4 Andromeda Parade, Robina

Price: \$1,400,000
Traded: 08 Apr 2025
Size: 297m²
4 bed, 3 bath, 3 car



275 Easthill Drive, Robina

Price: \$1,300,000
Traded: 19 Mar 2025
Size: 178m²
3 bed, 2 bath, 2 car



1/8 Roseville Court, Robina

Price: \$1,427,500
Traded: 14 Nov 2024
Size: 396m²
4 bed, 3 bath, 2 car



95 Bayswater Avenue, Varsity Lakes

Price: \$1,500,000
Traded: 18 Aug 2024
Size: 488m²
4 bed, 3 bath, 4 car

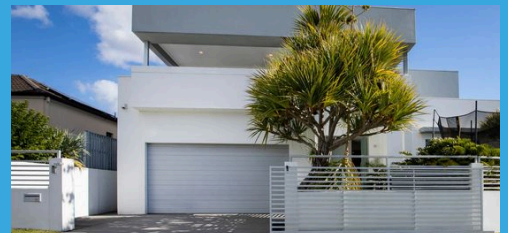

28 Heights Drive, Robina

Price: \$1,700,000
Traded: 27 Sept 2024
Size: 828m²
5 bed, 3 bath, 2 car

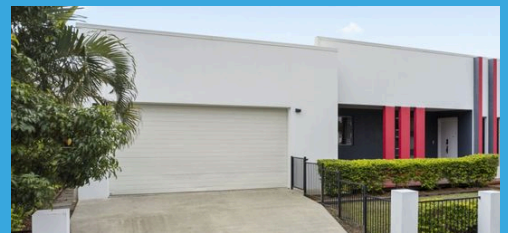

The information contained herein has been obtained through sources deemed reliable by M-Motion but cannot be guaranteed for its accuracy. We recommend to the buyer that any information, which is of special interest, should be obtained through independent verification.

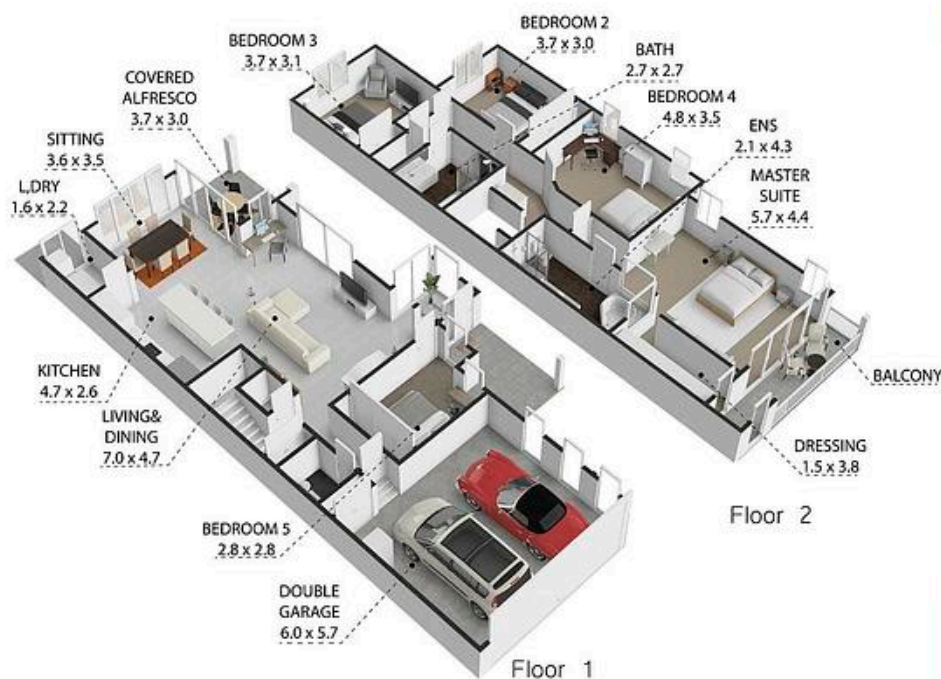

Site Plan



Whilst every attempt has been made to ensure the accuracy of the floor plan contained here, measurements of doors, windows, rooms and any other items are approximate and no responsibility is taken for any error, omission, or misstatement. This plan is for illustrative purposes only and should be used as such by any prospective purchaser.

2/30 Heights Drive, Robina, Qld 4226

5 | 2.5 | 2

All dimensions are approximate; they are subject to errors and inaccuracies and no liability will be accepted. Plans are shown for marketing purposes only.



M-MOTION
'real estate's new generation'

"Made for Family, Designed for Living"

Visit 30HeightsDr.com

Suburb Profile

Situated In the southern suburbs of the Gold Coast. Robina is renowned as one of the first master-planned residential communities in Australia. The successful development of Robina into a thriving residential and commercial hub has placed it among Australia's most effectively devised neighbourhoods and cemented its status as one of the Gold Coast's fastest growing suburbs.

Robina is home to many landmarks, including the popular Robina Town Centre – a shopping and dining precinct, Bond University and Robina Hospital. For the sports lovers, Robina offers the Glades Golf Course, as well as the Cbus Super Stadium which has been home to the Gold Coast Titans NRL team since 2008.

Robina enjoys excellent connectivity with other parts of the Gold Coast through its three main arterial roads and two major bus stations, which operate at regular and high frequency intervals.

With remarkable infrastructure and a wide selection of state and private schools, Robina is an ideal suburb for families. The suburb boasts a plethora of picturesque parks and is a mere short drive from stunning beaches and the idyllic hinterland.

Robina's unrivalled lifestyle offerings have generated a strong sense of attachment among its residents, making it a highly sought-after suburb.

Robina presents a compelling prospect for both residents and investors, with a growing population and impressive price appreciation. Its strategic location at the geographic heart of the Gold Coast, in close proximity to every essential amenity, yet sufficiently far from the tourist strip, has made it an immensely popular choice.





M-MOTION

'Real Estate's New Generation'



MICHAEL MAHON

M 0414 275 272

E michael@m-motion.com.au

1300MYSUCCESS

LAUREN MAHON, LL.B.

M 0491 111 939

E lauren.mahon@m-motion.com.au

m-motion.com.au